

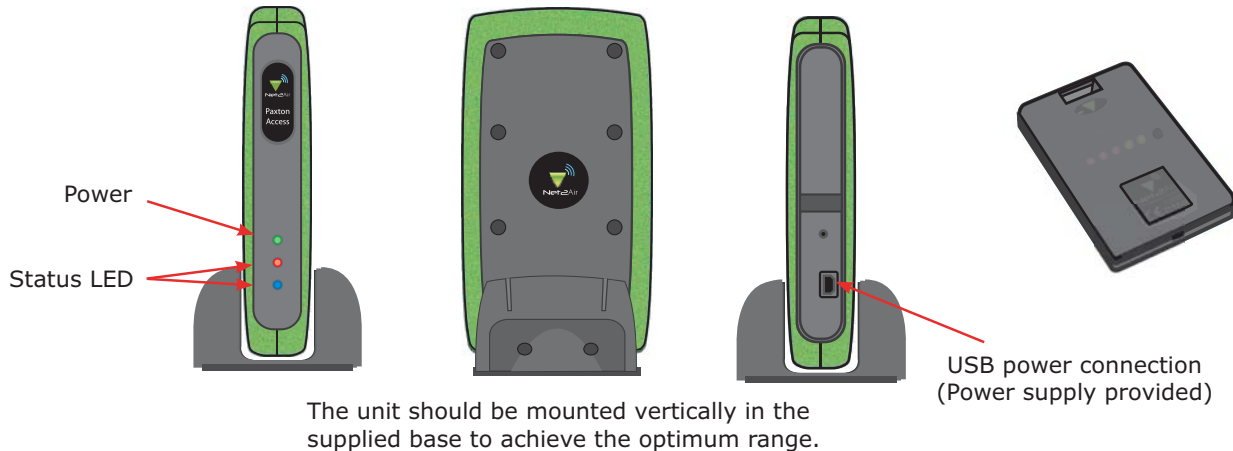

TransTech Systems, Inc.
Toll Free: 1-888-VIDEO-ID

Phone: 503-682-3292
Fax: 503-682-0166

Wilsonville, OR 97070
www.tsys.com



The kit consists of a transmitter base station and a hand held test card receiver. The card displays the signal condition on a row of LED's. No PC connection is required.

The base station is powered by a supplied mains power adaptor. This is plugged into the USB style connection.

The unit may also be powered directly by a PC using a USB cable but will show 'Windows needs to install driver software.' As you are only using the USB as a power source, no driver is required so select 'Don't show this message again'.

Once powered up, the unit will display a steady Green power LED and the other status LED's will flash alternately indicating that the unit is transmitting test data.

Press the card's button at locations intended for Net2 nano control units. The row of LED's on the card will indicate whether successful communications can be established.

NOTE: This checks the data content as well as signal strength to confirm reliable communication.

You must see at least one Green LED lit for a good signal condition. If only the Red LED's display, you should look for a better site; try re-locating the Nano or bridge into a more direct 'line of sight'.

See also:- [AN1096 - How to plan a Net2 nano site installation](http://paxton.info/975) < <http://paxton.info/975> >

Test Card - Replacing the Battery (CR2430)

To replace the battery, remove the screw, insert a flat blade tool into the slotted end (see label on card) and twist. The two halves of the case will separate. Replace the battery, clip the two halves together again and secure with the screw.

CE0889

The declaration of conformity may be consulted at: <http://paxton.info/596>